

FOR SALE

RESIDENTIAL - CONDOMINIUM 1,539SQFT (143SQM) / CALL FOR PRICE!

+65 9733 8283



Penthouse

TYPE C-P

1,539 sqft

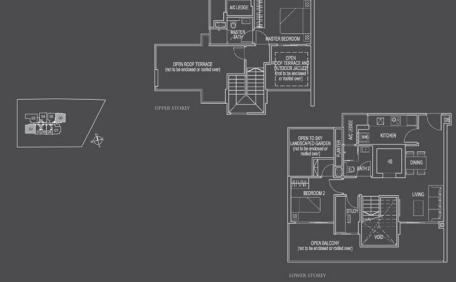

RESIDENTIAL - CONDOMINIUM

26, NEWTON ROAD, NEWTON, NOVENA, SINGAPORE
307957

- LISTING ID: SGLD39071108
- TENURE: FREEHOLD
- TITLE: N/A
- SIZE BUILT-UP: 1,539SQFT (143SQM)
- SIZE LAND: 37,577SQFT (3,491SQM)
- NO. OF FLOORS: 26
- FLOOR/LEVEL: N/A - PENTHOUSE
- BED ROOMS: 2+1
- BATH ROOMS: 2
- MAIDS ROOMS: N/A
- PARKING SPACES: N/A
- LAYOUT TYPE: END LOT
- FACING: WEST
- VIEWING: OTHER
- SELLING PRICE: **CALL FOR PRICE!**
- COMPLETION YEAR: 2016
- CONDITION: ORIGINAL CONDITION
- FURNISHING: PARTIALLY FURNISHED
- LISTING DATE: APR 27, 2021

26 NEWTON

Spacious 1,539sqft (143sqm), partially furnished, 2 bedroom, 2 bathroom Condominium for Sale. Completed in 2016, this penthouse end lot unit is in original condition. Others: Freehold, facing west, 1 other room(s) This property is currently vacant and ready to move in. Located in Singapore's district D11 near Newton, Novena in the area Newton (Central region).

INTERIOR FACILITIES

- Air-Conditioning
- Internet Connection
- Private Garden
- Balcony
- Jacuzzi

OTHER INTERIOR FEATURES

- Cooker Hob/Hood
- Dryer
- Dishwasher
- Fridge

EXTERIOR FACILITIES

- 24 Hours Security
- Swimming Pool
- Covered Car Park
- Wading Pool

VISIT THIS PROPERTY AT: <https://www.thesingaporehome.com/property/SGLD39071108>

CLARA CHAN - HUTTONS ASIA PTE LTD

3 Bishan Place #05-01 CPF Bishan Building
D20, 579838, Singapore

+65 9733 8283
WhatsApp Me

clarachan33@gmail.com

<https://www.thesingaporehome.com>



Scan QR Code

Huttons® Call for Viewing
The Agency of Choice +65-97338283